

Nivz Valves & Automation

BUTTERFLY VALVE, Flanged End, Center Disc

DRG. No.: FBFSP1/6

00
Rev. No.

Pressure Rating : PN 10
 Body Design : Double Flanged, Rubberlined, Center Disc
 End Connection : Flanged End
 Flange Drilling : As Per ANSI B 16.5. Class 150 OR
 As Per Your Request Dimension

Nomenclature:-

NO.	PART NAME	MATERIAL
1	Body	Cast Iron-A 106 GR. B/Ductile Iron ASTM A 216 GR. WCB/ ASTM A 351 GR. CF8/8M/3/3M
2	Disc	C.I./D.I./WCB/CF8/8M/CF3/3M
3	Upper Stem	A 216 T-410/304/316/304L/316L
4	Lower Stem	A 216 T-410/304/316/304L/316L
5	Body Seat	Nitrile/EPDM/NBR/Hypalon/Buna-N Ebonite/Neoprene/Silicon/Viton
6	Disc Lock Bolt	S.S. 304/316
7	Bottom Cover	C.S./S.S.304/316/304L/316L
8	Stem Seal Top	Nitrile/EPDM/Neoprene/Silicon/Viton
9	Bottom Seal	Nitrile/EPDM/Neoprene/Silicon/Viton
10	Gear Box	Worm & Gear Type, Quarter Turn
11	Hand Wheel	C.S. Fabricated

Design Standard : BS 5155/API 609

Testing Standard : BS 6755-I

Test Pressure in PSIG/BAR/KG./CM ²			
Test	Hydrostatic		
Pr. Rating	PN10		
Body	215	14.7	15
Seat	145	9.8	10

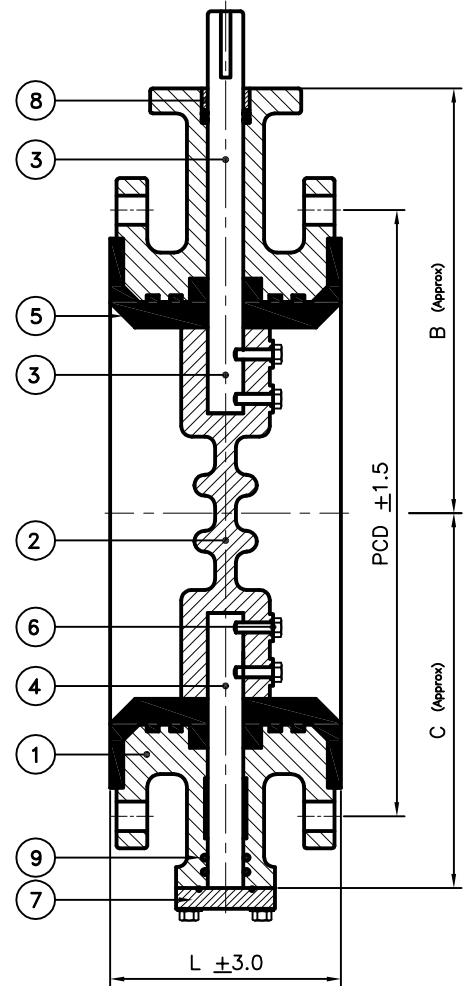
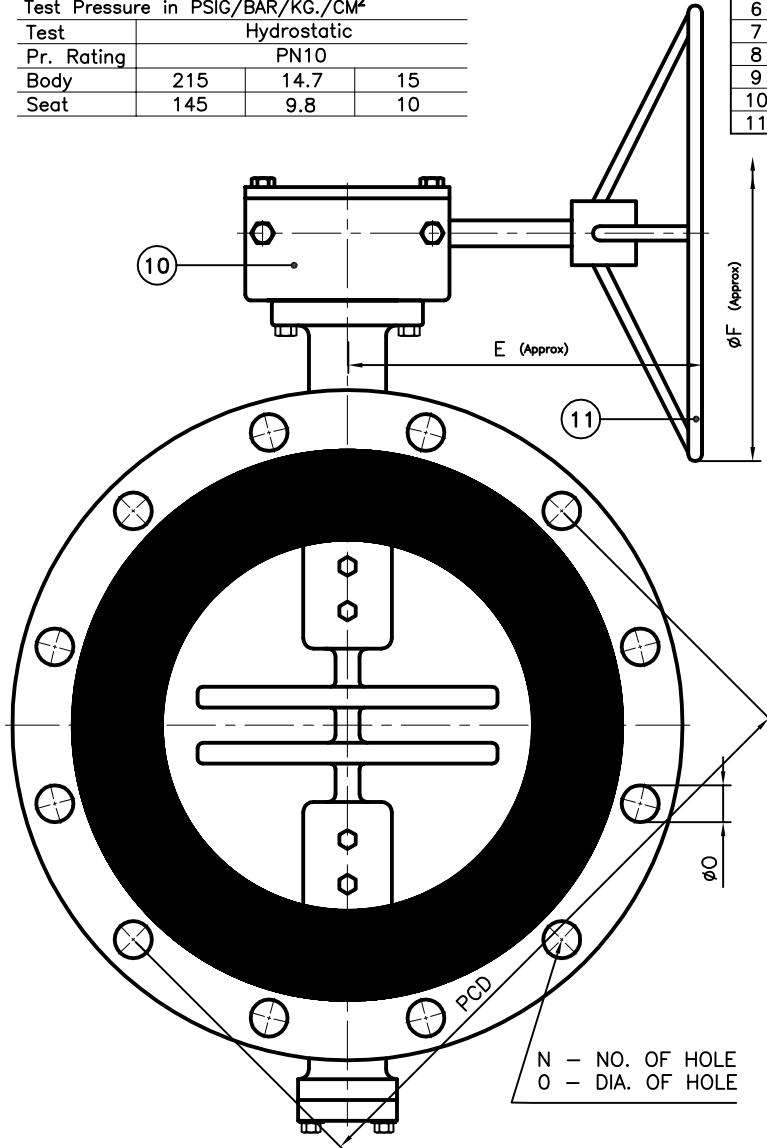

N - NO. OF HOLE
 Ø - DIA. OF HOLE

Design Standard : BS 5155/API 609

Dimensions [PN 10]

SIZE	200	250	300	350	400	450	500	600
L	152	165	178	190	216	222	229	267
B	250	285	310	340	376	390	425	500
C	175	208	227	275	308	373	408	464
E	285	285	285	300	305	305	370	350
F	300	350	350	350	500	500	500	600
PCD	298.4	361.9	431.8	476.2	539.7	577.8	635	749.3
N	8	12	12	12	16	16	20	20
øD	22.2	25.4	25.4	28.6	28.6	31.7	31.7	34.9
ISO 5211 FLANGE	F07	F10	F10	F12	F14	F14	F16	F16

All Dimensions Are In mm



VALVES & AUTOMATION
www.nivzvalves.com

Client _____

Order / Enq. No. _____

Job / Project _____

Manufactured By : **Nivz Valves & Automation**, Ahmedabad, Gujarat, INDIA.

Do Not Copy Drawing

© COPYRIGHT

Due to continuous development programme, the design and data given in this leaflet are subject to change without prior notice

Appd. _____

Chkd. _____

Drwn. _____

For Reference

For Approval

