

# Nivz Valves & Automation

4 Way Ball Valve, Full Bore, Flanged, 150#

DRG. No.: F109X

00  
Rev. No.

Design Standard : BS EN ISO 17292/  
ASME B 16.34

Dimensions [150 Class]

SIZE	15	20	25	40	50	65	80	100	150
L	124	142	165	215	245	295	325	380	520
ØG	12.5	19	25	38	50	63	75	100	150
ØD	89	98.5	108	127	152.4	177.8	190.5	228.6	279
ØE	60.3	69.8	79.3	98.4	120.6	139.7	152.4	190.5	241.3
ØF	35	43	50.8	73	92.1	104.7	127	157.2	215.9
N	4	4	4	4	4	4	4	8	
ØO	15.8	15.8	15.8	15.8	19	19	19	19	22.2
T	10.2	10.5	11.2	14.5	15.5	17.5	19	23.8	25.4

All Dimensions Are In mm

## Nomenclature:-

NO.	PART NAME	MATERIAL
1	Body	A 216 GR. WCB
2	Side Piece	A 351 GR. CFB/CF8M/CF3/CF 3M
3	Ball	AISI 304/316/304L/316L/CF8/8M/3/3M
4	Stem	AISI 304/316/304L/316L
5	Ball Seat	P.T.F.E.(VIRGIN)/GFT/CARBON FILLED
6	Body Seal	P.T.F.E.(VIRGIN)/GFT/CARBON FILLED
7	Gland Seal	P.T.F.E.(VIRGIN)/GFT/CARBON FILLED
8	Gland Bush	AISI 304/316/304L/316L
9	Gland Nut	C.S./194 GR. 2H/S.S. 304/316
10	Hand Lever	CARBON STEEL/S.S.
11	Hand Lever Nut	C.S./194 GR. 2H/S.S. 304/316
12	Lever Sleeve	P.V.C.

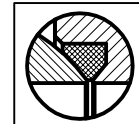
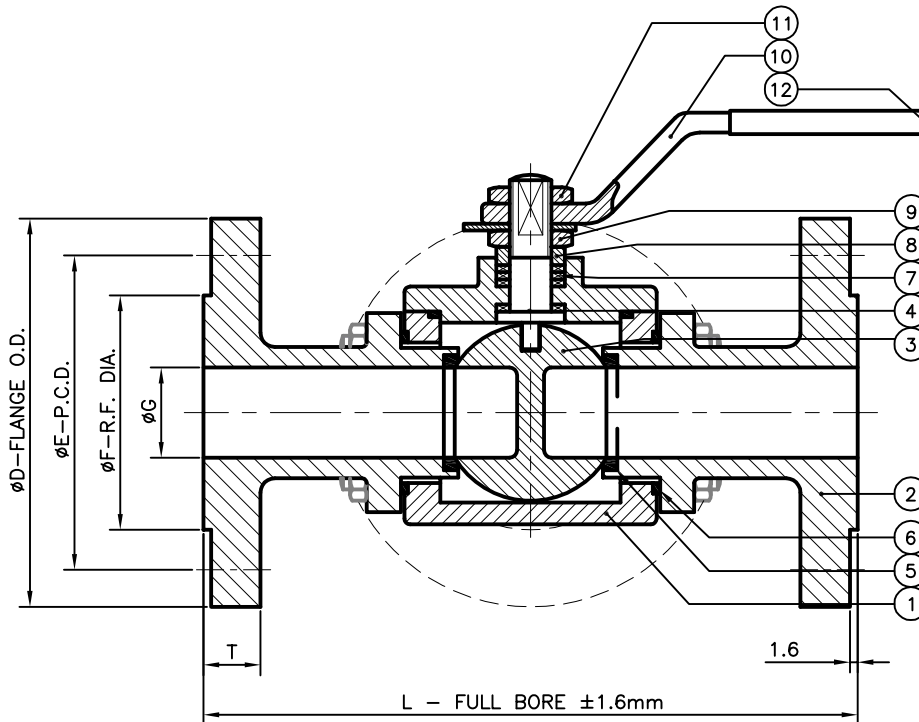

FIRE SAFE DESIGN

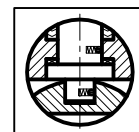

ANTISTATIC DEVICE



Different Position of 'L' Port

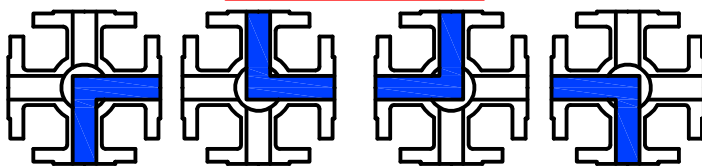

Different Position of 'T' Port

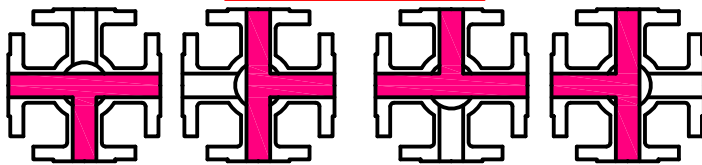

Different Position of Double 'L' Port

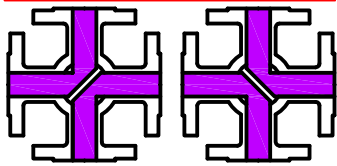

Different Position of 'Straight' Port

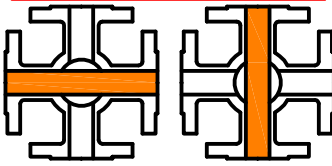

Testing Standard : BS EN 12266 I/  
API 607

Test Pressure in PSIG/BAR/KG./CM <sup>2</sup>		Air			
Test	Hydrostatic				
Pr. Rating	150#				
Body	425	29.3	30		
Seat	300	20.7	21	80	5.5 5.6

**nivz**™  
VALVES & AUTOMATION  
[www.nivzvalves.com](http://www.nivzvalves.com)

Client \_\_\_\_\_  
Order / Enq. No. \_\_\_\_\_  
Job / Project \_\_\_\_\_  
Manufactured By : **Nivz Valves & Automation**, Ahmedabad, Gujarat, INDIA.

Do Not Copy Drawing  
©COPYRIGHT

Due to continuous development programme, the design and data given in this leaflet are subject to change without prior notice

Appd. \_\_\_\_\_

Chkd. \_\_\_\_\_

Drwn. \_\_\_\_\_

For Record

For Reference

For Approval